

**RUSH
WITT &
WILSON**



Flat 1, 55 Elphinstone Road, Hastings, TN34 2EG
Offers In Excess Of £155,000

Welcome to this TWO BEDROOM period maisonette located on Elphinstone Road in Hastings. This property comes with a SHARE OF FREEHOLD and offers a fantastic opportunity for those looking to create their dream home, as it requires modernisation throughout, making it an ideal project for renovation enthusiasts. Upon entering, you are greeted by a large sitting room with a rear aspect, with the kitchen located to the front aspect. In between is the spiralling staircase leading to the upper floor. With one bathroom and two well-proportioned bedrooms, this maisonette provides ample space for comfortable living. The spacious layout allows for flexibility in design and furnishing, giving you the freedom to tailor the space to your liking. The added benefit to this property is the parking space to the front which is a rare addition in properties like this. Located in a desirable area, this property is surrounded by amenities and is within easy reach of local shops, restaurants, and transport links. Don't miss out on the opportunity to transform this property into a stunning home. Book a viewing today and let your creativity flourish in this wonderful space on Elphinstone Road.





RUSH
WITT &
WILSON



RUSH
WITT &
WILSON



RUSH
WITT &
WILSON



RUSH
WITT &
WILSON





Floor 0

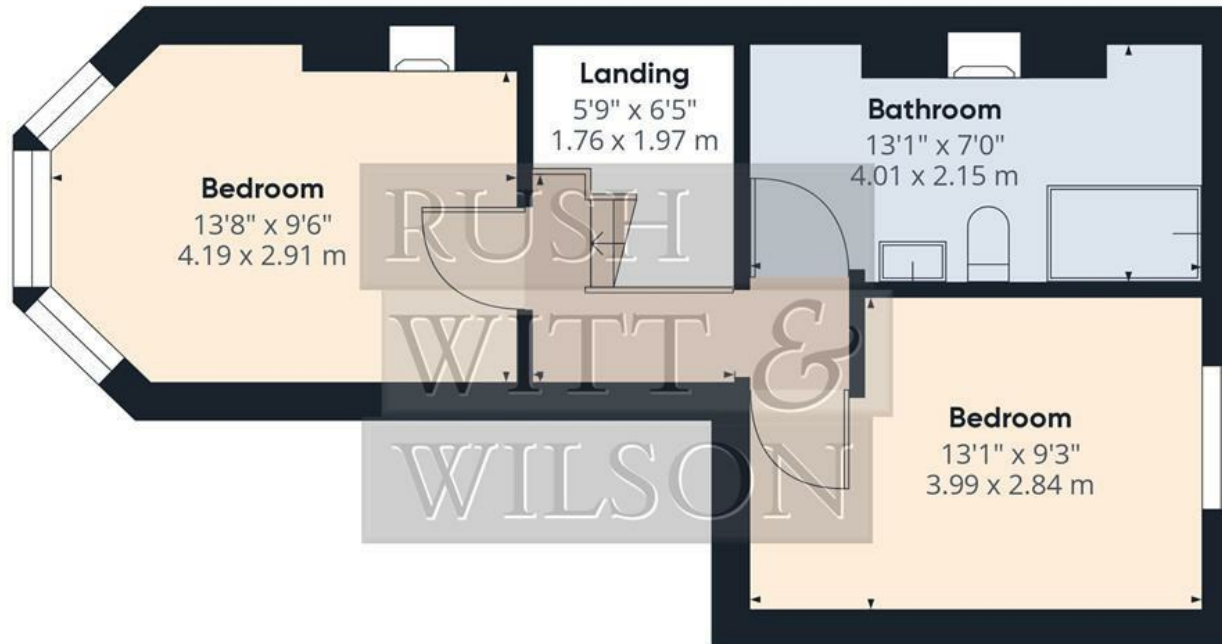

Floor 1

Approximate total area⁽¹⁾

795.13 ft²

73.87 m²

Reduced headroom

14.01 ft²

1.3 m²

(1) Excluding balconies and terraces

Reduced headroom

..... Below 5 ft/1.5 m

While every attempt has been made to ensure accuracy, all measurements are approximate, not to scale. This floor plan is for illustrative purposes only.

Calculations are based on RICS IPMS 3C standard.

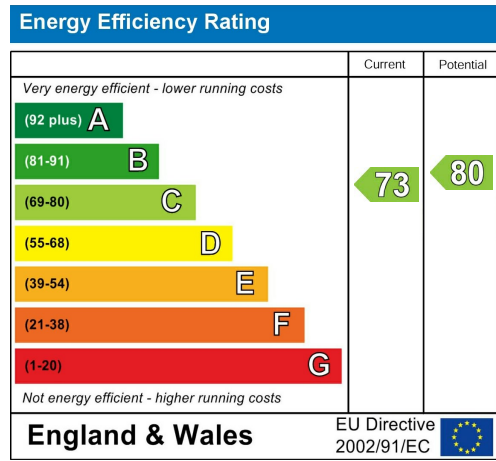
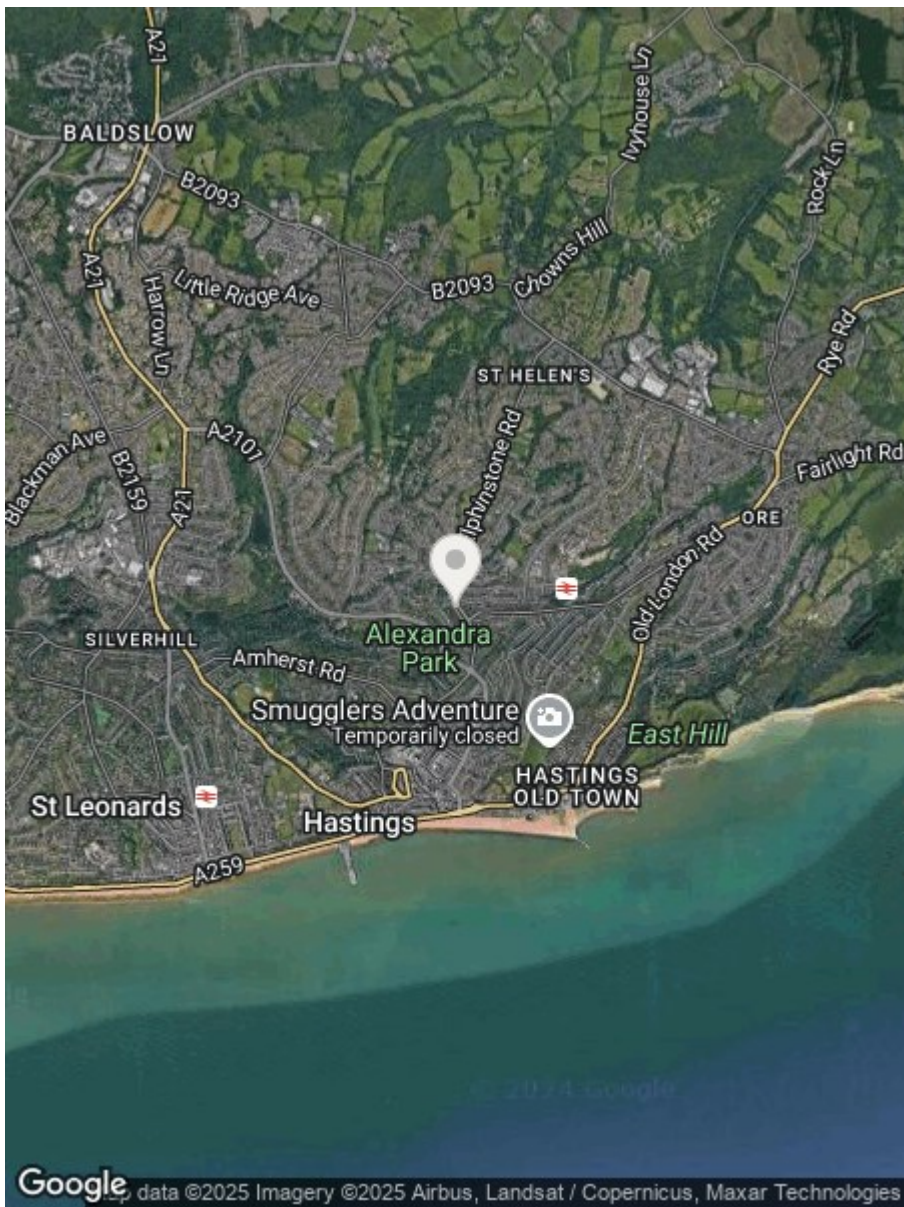

**RUSH
WITT &
WILSON**

**Residential Estate Agents
Lettings & Property Management**



**Rother House Havelock Road
Hastings
East Sussex
TN34 1BP
Tel: 01424 442443
hastings@rushwittwilson.co.uk
www.rushwittwilson.co.uk**